

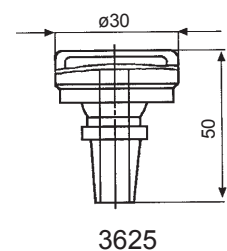

Pistehitsaustarvikkeet

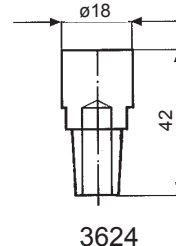

Pistehitsaustarvikkeet

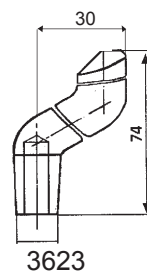
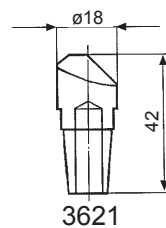
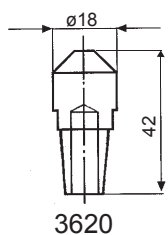
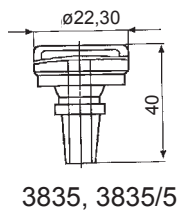
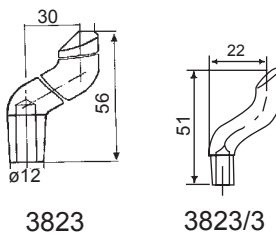
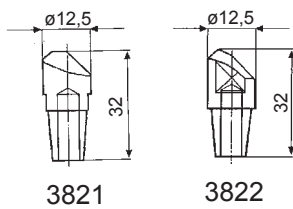
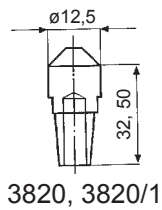
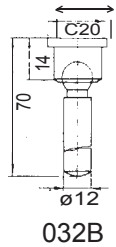
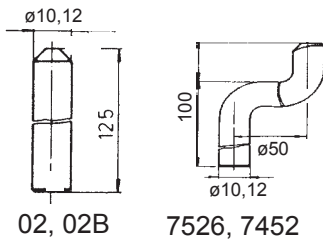

Ilmajäähdytteiset 10 ja kärjet pihdeille

| Tuotekoodi | Tuote | | | |
|-------------|-------|------------|-------|-------|
| 02 | 02 | Suora | Ø10mm | L=125 |
| 00100181547 | 02B | Suora | Ø12mm | L=125 |
| 00100107526 | 7526 | Taivutettu | Ø10mm | L=125 |
| 00100182547 | 7452 | Taivutettu | Ø12mm | L=100 |
| 032B | 032B | Nivel | Ø12mm | Ø=20 |

Vesijäähdytteiset 11 mm kärjet pihdeille

| Tuotekoodi | Tuote | | |
|-------------|--------|----------------|------|
| 00100103820 | 3820 | Suora keskellä | L=32 |
| 00100103821 | 3821 | Suora reunassa | L=32 |
| X0700101927 | 3820/1 | Suora keskellä | L=50 |
| 00100103822 | 3822 | Vino reunassa | L=32 |
| 00100103823 | 3823 | Taivutettu | L=56 |
| X0440100228 | 3823/3 | Taivutettu | L=51 |
| 00100103835 | 3835 | Nivel | Ø=22 |
| X0700101762 | 3835/5 | Nivel | Ø=30 |

Vesijäähdytteiset 15 mm kärjet pistekoneille

| Tuotekoodi | Tuote | | |
|-------------|-------|----------------|------|
| 00100103620 | 3620 | Suora keskellä | L=42 |
| 00100103621 | 3621 | Suora reunassa | L=42 |
| 00100103623 | 3623 | Taivutettu | L=74 |
| 00100103624 | 3624 | Tasa | L=42 |
| 00100103625 | 3625 | Nivel | Ø=30 |

Pistehitsaustarvikkeet

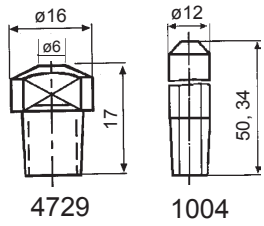

4729

1004

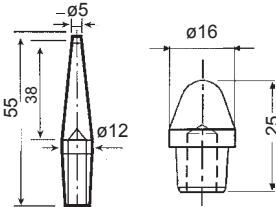

1018

2625

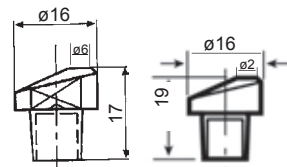

4727

4727/0

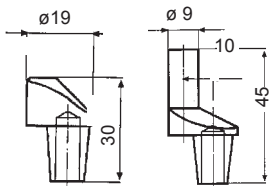

1034

1051/B

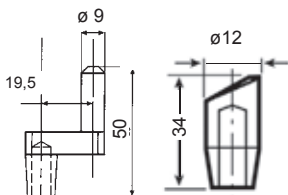

14766

X0700100831

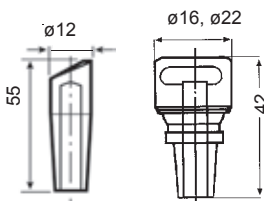

X0700100829

399, 1072

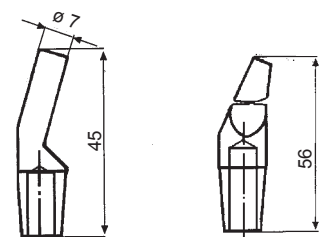

1054/B

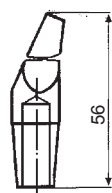

1055

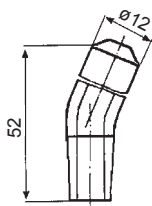

1048

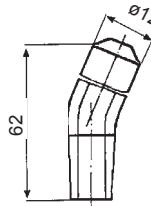

1049

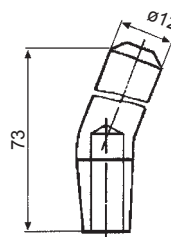

1050

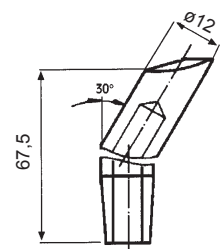

1051

Vesijäähdytteiset Ø12 mm 10 % kärjet

| Tuotekoodi | Tuote | | |
|-------------|--------|---------------------|--------|
| 00100173559 | 4729 | Suora keskellä | L=17 |
| X0700101997 | 1004 | Suora keskellä | L=34 |
| 1004 | 1004 | Suora keskellä | L=50 |
| 1018 | 1018 | Suora keskellä | L=55 |
| 00100102625 | 2625 | Pyöreä | L=25 |
| 00100173554 | 4727 | Suora reunassa | L=17 |
| X0700100698 | 4727/0 | Suora reunassa | L=19 |
| 1034 | 1034 | Suora reunassa | L=30 |
| 1051/B | 1051/B | Suora reunassa | L=45 |
| 14766 | 14766 | Suora reunassa | L=50 |
| X0700100831 | | Vino reunassa | L=34 |
| X0700100829 | | Vino reunassa | L=55 |
| 00100100399 | 399 | Pallonivel | Ø16 |
| 1072 | 1072 | Pallonivel | Ø22 |
| 1054/B | 1054/B | Taivutettu tasa | L=45 |
| 1055 | 1055 | Vino tasa | L=55 |
| 1048 | 1048 | Taivutettu keskellä | L=52 |
| 1049 | 1049 | Taivutettu keskellä | L=62 |
| 1050 | 1050 | Taivutettu keskellä | L=73 |
| 1051 | 1051 | Taivutettu reunassa | L=67,5 |

Piippukärjenpitimet

| | | | |
|--------|------|-------------------|-------|
| 6037 | 4726 | Kärjenpidin suora | L=105 |
| 6037/1 | 4726 | Kärjenpidin vino | L=105 |

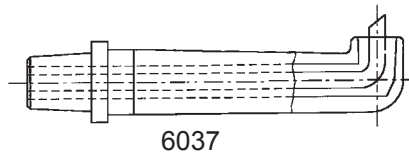

6037

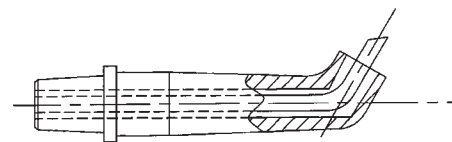

6037/1

Pistehitsaustarvikkeet

Vesijähdytteiset 13 mm kärjet pistekoneille

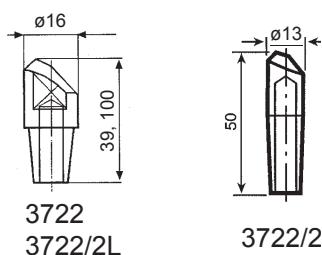
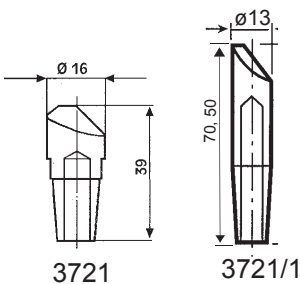
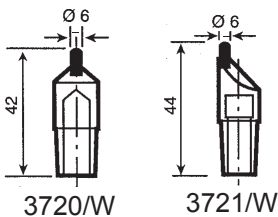
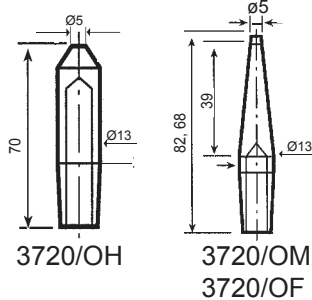
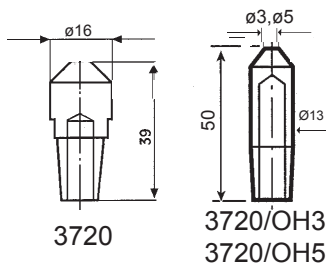

| Tuotekoodi | Tuote | | |
|-------------|----------|------------------------|-------|
| 00100103720 | 3720 | Suora keskellä | L=39 |
| X0700100550 | 3720/OH3 | Suora keskellä | L=50 |
| X0700101698 | 3720/OH5 | Suora keskellä | L=50 |
| X0700101549 | 3720/OH | Suora keskellä | L=70 |
| X0700101212 | 3720/OM | Suora keskellä | L=82 |
| X0700101370 | 3720/OF | Suora keskellä | L=68 |
| X0700100349 | 3720/W | Suora keskellä Wolfram | L=42 |
| X0700100348 | 3721/W | Suora reunassa Wolfram | L=44 |
| 00100103721 | 3721 | Suora reunassa | L=39 |
| X0700101794 | 3721/1 | Suora reunassa | L=50 |
| X0700101548 | 3721/1 | Suora reunassa | L=70 |
| 00100103722 | 3722 | Vino reunassa | L=39 |
| X0700100675 | 3722/2 | Vino reunassa | L=50 |
| X0700100960 | 3722/2L | Vino reunassa | L=100 |
| 00100103723 | 3723 | Taivutettu | L=74 |
| X0440100157 | 3723/3 | Taivutettu | L=92 |
| X0440100198 | 3723/3L | Taivutettu | L=105 |
| 00100103724 | 3724 | Tasa | L=39 |
| 00100103725 | 3725 | Nivel | Ø=30 |
| X0440100199 | 3725/5 | Nivel | Ø=22 |
| X0700101680 | 3725/5 | Nivel, kaasu | Ø=22 |

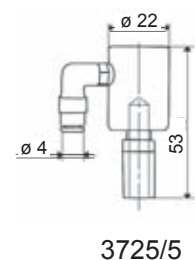
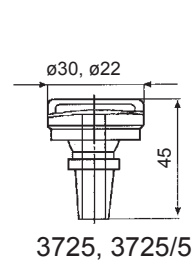
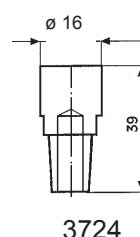
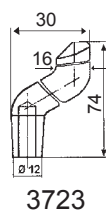
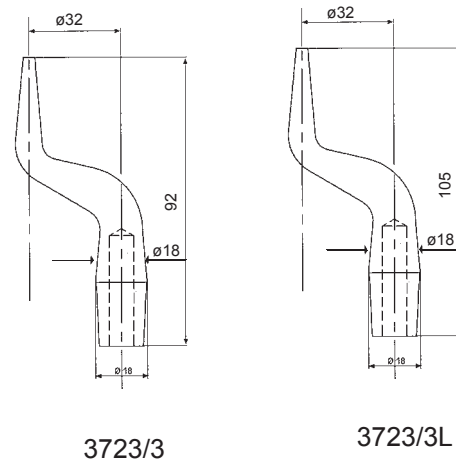

Pistehitsaustarvikkeet

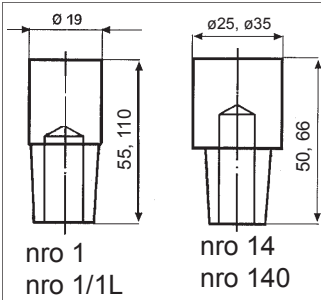

nro 1
nro 1/1L

nro 14
nro 140

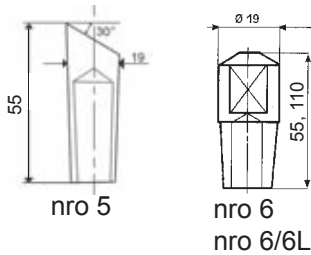

nro 5

nro 6
nro 6/6L

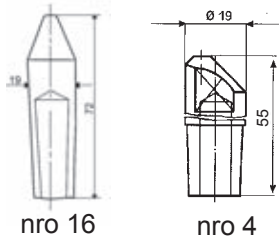

nro 16

nro 4

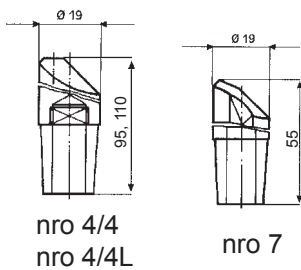

nro 4/4
nro 4/4L

nro 7

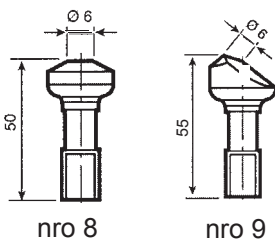

nro 8

nro 9

Vesijähdytteiset 19 mm kärjet pistekoneille

| Tuotekoodi | Tuote | | | |
|-------------|-----------------|----------------------|-------|------|
| X0700100761 | nro 1 | Tasa | L=55 | Ø=19 |
| X0700101749 | nro 1/1L | Tasa | L=110 | Ø=19 |
| X0700100579 | nro 14 | Tasa | L=50 | Ø=25 |
| X0700101562 | nro 140 | Tasa | L=50 | Ø=35 |
| X0700101733 | nro 5 | Tasa vino | L=55 | |
| X0700100152 | nro 6 | Suora keskellä | L=55 | |
| X0700100524 | nro 16 | Suora keskellä | L=72 | |
| X0700100871 | nro 6/6L | Suora keskellä | L=110 | |
| X0700100389 | nro 4 | Suora reunassa | L=55 | |
| X0700101050 | nro 4/4 | Suora reunassa | L=95 | |
| X0700100870 | nro 4/4L | Suora reunassa | L=110 | |
| X0700100766 | nro 7 | Vino reunassa | L=55 | |
| X0700100873 | nro 8 | Suora keskellä | M10 | |
| X0700100874 | nro 9 | Vino reunassa | M10 | |
| X0440100203 | nro 13 | Nivel | Ø= 22 | |
| X0440100113 | nro 12 | Nivel | Ø= 32 | |
| X0440100207 | nro 26 | Taivutettu | L=100 | |
| X0440100145 | nro 10 | Taivutettu | L=115 | |
| X0700101959 | nro 10/10 | Taivutettu tasa | L=105 | |
| X0700100525 | nro 100 | Taivutettu | L=115 | |
| X0700101948 | nro 101 | Taivutettu tappi Ø=8 | L=110 | |
| X0700101949 | nro 160 | Suora keskellä | L=90 | |
| X0700100746 | nro 161 | Suora keskellä | L=120 | |
| X0700101444 | nro 163 | Suora keskellä | L=98 | |
| | mutteripidin M4 | | L=90 | |
| | mutteripidin M5 | | L=90 | |
| | mutteripidin M6 | | L=90 | |
| | mutteripidin M8 | | L=90 | |
| X0700101681 | | | | |

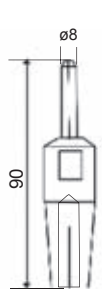

nro 160

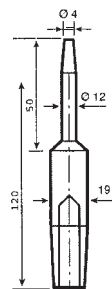

nro 161

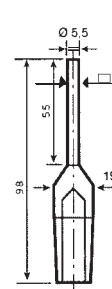

nro 163

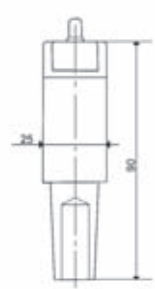

mutteripidin

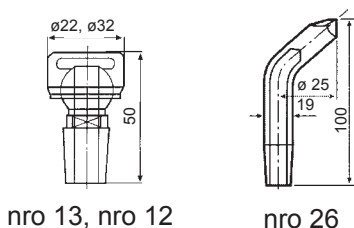

nro 13, nro 12

nro 26

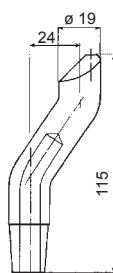

nro 10

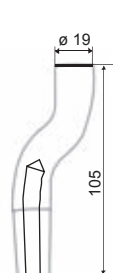

nro 10/10

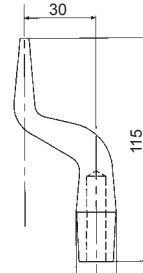

nro 100

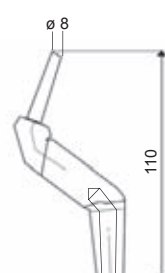

nro 101

Pistehitsaustarvikkeet

Erikoiskärjenpitimet

| Tuotekoodi | Tuote | | | Kuvanro |
|-------------|-------------|-------------|------|---------|
| 00100220070 | Kärjenpidin | kartio 9001 | Ø=19 | 1 |
| 00100220072 | Kärjenpidin | kartio 9001 | Ø=21 | 2 |
| 00100220074 | Kärjenpidin | kartio 9001 | Ø=25 | 3 |
| 00100220075 | Kärjenpidin | kartio 9001 | Ø=30 | 4 |

Erikoiskärjenpitimeen sopivat kärjet

| Tuotekoodi | Tuote | | | |
|-------------|-------|----------------|------|---|
| 9001 | 9001 | Suora keskellä | L=12 | 5 |
| X0700101546 | 9001 | Suora keskellä | L=50 | 6 |

Erikoiskärjenpidinsarja

| Tuotekoodi | Tuote | | | |
|------------|----------------------------|-------------|--|------|
| 32522A | Kärjenpidinsarja L=200 | | | |
| | suora (A) kartio 37 | Ø=25 , L=75 | | 7(A) |
| 32523B | Kärjenpidinsarja L=200 | | | |
| | vino (B) kartio 37 | Ø=25 , L=75 | | 8(B) |

Erikoiskärjenpitimeen sopivia kärkiä

| | | | |
|-------------|----------|----------------|------|
| X0700101698 | 3720/OH5 | Suora keskellä | L=50 |
| X0700100675 | 3722/2 | Vino reunassa | L=50 |

Erikoiskärjenpidinsarja

| | | | |
|-------------|--|------|----|
| X0700200520 | Erikoiskärjenpidin L=250 kartio Ø12mm10% | Ø=30 | 9 |
| X0700200519 | Erikoiskärjenpidin L=150 kartio Ø12mm10% | Ø=30 | 10 |

Erikoiskärjenpitimeen sopivia kärkiä

| Tuotekoodi | Tuote | | |
|------------|-------|---------------------|------|
| 1048 | 1048 | Taivutettu keskellä | L=53 |
| 1049 | 1049 | Taivutettu keskellä | L=62 |
| 1050 | 1050 | Taivutettu keskellä | L=73 |

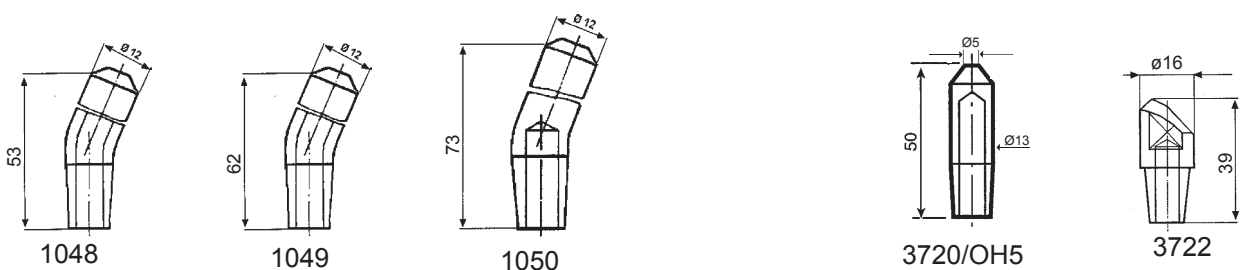
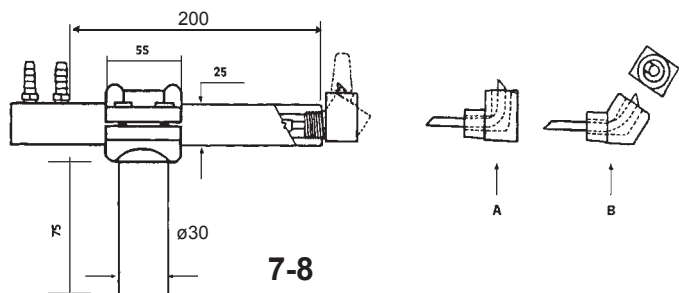
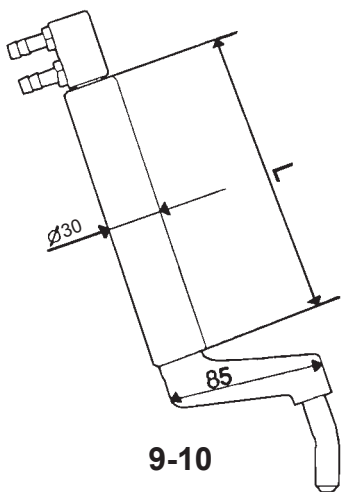
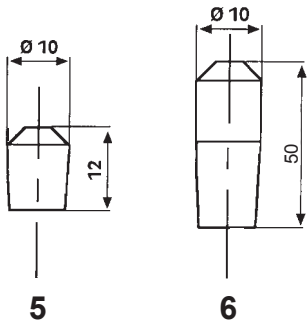
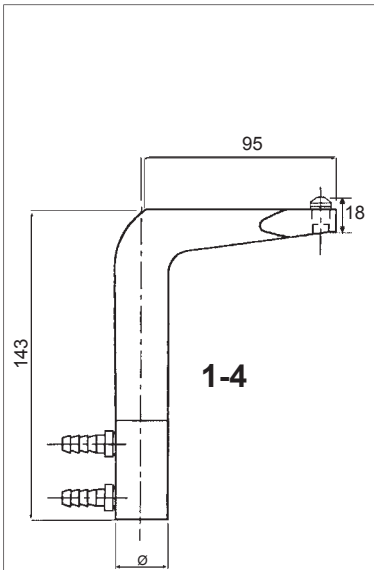

Pistehitsaustarvikkeet

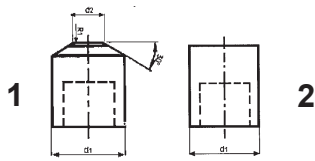

1

2

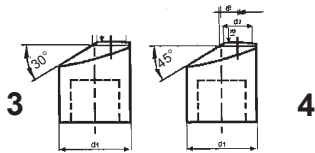

3

4

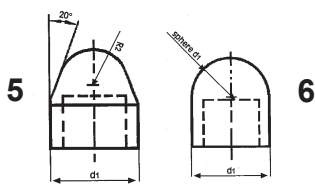

5

6

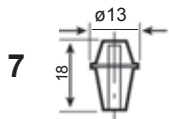

7

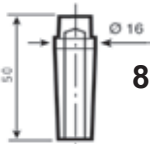

8

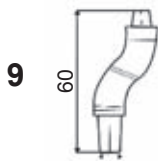

9

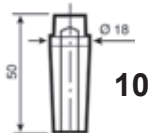

10

Pistehitsaushatut

| Tuotekoodi | Tuote | | Kuvanro |
|-------------|--------------|-------------------------|---------|
| B13 | Hattu B13 | $d_1=13$ Suora keskellä | 1 |
| C13 | Hattu C13 | $d_1=13$ Tasa | 2 |
| D13 | Hattu D13 | $d_1=13$ Suora reunassa | 3 |
| E13 | Hattu E13 | $d_1=13$ Pyöreä | 5 |
| F13 | Hattu F13 | $d_1=13$ Pyöreä | 6 |
| B16 | Hattu B16 | $d_1=16$ Suora keskellä | 1 |
| C16 | Hattu C16 | $d_1=16$ Tasa | 2 |
| D16 | Hattu D16 | $d_1=16$ Suora reunassa | 3 |
| 00100100364 | Hattu D/1 16 | $d_1=16$ Suora reunassa | 4 |
| E16 | Hattu E16 | $d_1=16$ Pyöreä | 5 |
| F16 | Hattu F16 | $d_1=16$ Pyöreä | 6 |

Pistehitsaushatunpitimet

| Tuotekoodi | Tuote | | Kuvanro |
|-------------|------------------------|-------|---------|
| X0700101371 | 38 Hatunpidin $d_1=16$ | L=18 | 7 |
| X0700101528 | 37 Hatunpidin $d_1=13$ | L=50 | 8 |
| X0700100808 | 37 Hatunpidin $d_1=13$ | L=60 | 9 |
| X0700101529 | 36 Hatunpidin $d_1=16$ | L=50 | 10 |
| X0700101006 | 19 Hatunpidin $d_1=13$ | L=50 | 11 |
| X0700101530 | 19 Hatunpidin $d_1=16$ | L=50 | 12 |
| X0700101531 | 19 Hatunpidin $d_1=16$ | L=80 | 13 |
| X0700101748 | 19 Hatunpidin $d_1=16$ | L=103 | |
| X0700100810 | 19 Hatunpidin $d_1=16$ | L=95 | |

Pistehitsausadapterit

| Tuotekoodi | Tuote | | Kuvanro |
|--------------|-------------------------------|------|---------|
| X0700101403 | 12 mm 10% Suora adapteri 37 | L=30 | 14 |
| X0700101850 | 37 Adapteri 12 mm 10% | L=30 | 14 |
| X0700101401 | 36 Adapteri kartio 37 | L=30 | 15 |
| X0700101402 | 19 Adapteri kartio 37 | L=42 | 16 |
| X0700101108 | 19 Adapteri kartio, 12 mm 10% | L=50 | 17 |
| X0700101532A | 19 mm S-adapteri, 12 mm 10% | L=95 | 18 |

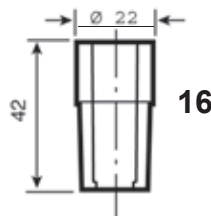

16

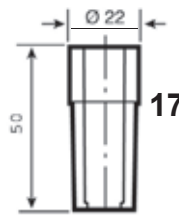

17

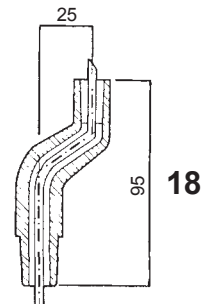

18

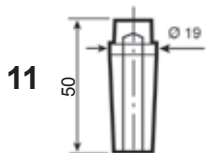

11

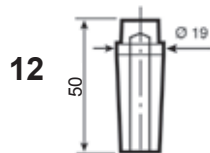

12



13

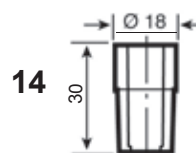

14

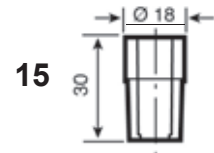

15

Pistehitsaustarvikkeet

Vesijäähdytteiset kärjenpitimet

| Tuotekoodi | Tuote | | Kuvanro |
|-------------|-------------------------------------|------|---------|
| X0700200435 | Kärjenpidin, L=45 kartio 38 | D=14 | 1 |
| X0700200436 | Kärjenpidin, L=85 kartio 38 | D=14 | 2 |
| X0700200203 | Kärjenpidin, L=150 kartio 38 | D=14 | 3 |
| X0700200504 | Kärjenpidin, L=85 kartio 38 | D=16 | 4 |
| 22013 | Kärjenpidin, L=200 kartio 37 | D=19 | 5 |
| 22015 | Kärjenpidin, L=300 kartio 37 | D=19 | 6 |
| 22016 | Kärjenpidin, L=400 kartio 37 | D=19 | 7 |
| 22021 | Kärjenpidin, L=200 kartio 37 | D=20 | 8 |
| 00100220028 | Kärjenpidin, L=200 kartio 37 | D=21 | 9 |
| 00100271064 | Kärjenpidin, L=150 kartio 37 | D=22 | 10 |
| 00100271063 | Kärjenpidin, L=260 kartio 37 | D=22 | 11 |
| 22036 | Kärjenpidin, L=150 kartio 37 | D=25 | 12 |
| 22038 | Kärjenpidin, L=240 kartio 37 | D=25 | 13 |
| 22041 | Kärjenpidin, L=400 kartio 37 | D=25 | 14 |
| 22039 | Kärjenpidin, L=300 kartio 36 | D=25 | 15 |
| A22036 | Kärjenpidin, L=150 kartio 19 | D=25 | 16 |
| A22038 | Kärjenpidin, L=240 kartio 19 | D=25 | 17 |
| X0700200279 | Kärjenpidin, L=85 kartio 19 | D=30 | 18 |
| 22051 | Kärjenpidin, L=200 kartio 19 | D=30 | 19 |
| 22051 Auto | Kärjenpidin, L=200 kartio 19 | D=30 | 20 |
| 22053 | Kärjenpidin, L=300 kartio 19 | D=30 | 21 |
| 22053 Auto | Kärjenpidin, L=300 kartio 19 | D=30 | 22 |
| 22054 | Kärjenpidin, L=400 kartio 19 | D=30 | 23 |
| A22053 | Kärjenpidin, L=300 kartio 37 | D=30 | 24 |
| 00100220063 | Kärjenpidin, L=300 kartio 19 | D=32 | 25 |
| 22071 | Kärjenpidin, L=240 kartio 19 | D=35 | 26 |
| 00500204021 | Kärjenpidinpari 4021 H=75 kartio 87 | | 27 |

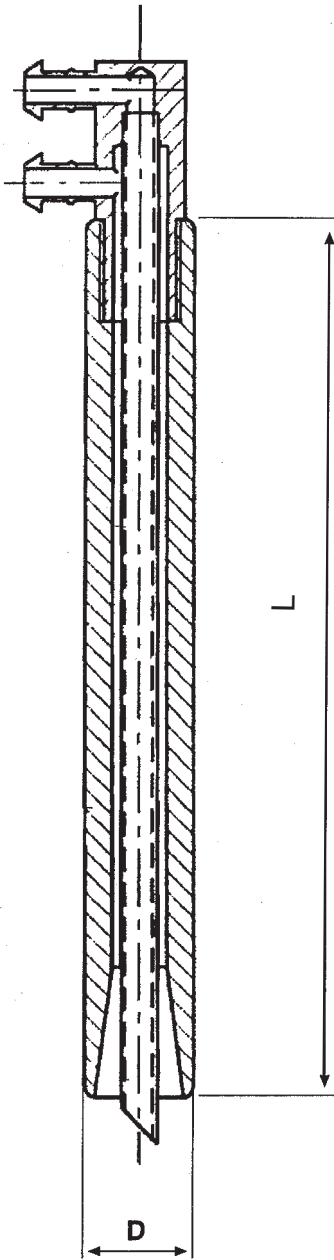

Kuvat
1-26



27

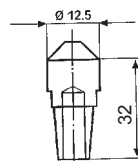

3820

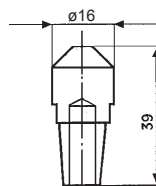

3720

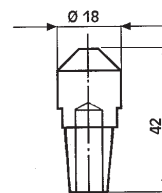

3620

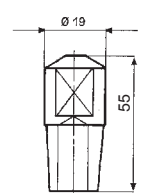

Nro 6

Pistehitsaustarvikkeet

Ilmajäähdytteiset varsiparit 8415, 7900, 7901, 7920

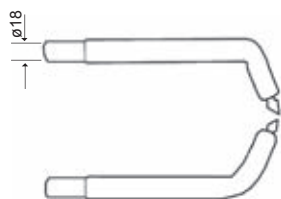

2

| Tuotekoodi | Tuote | | | Kuvanro |
|------------|-----------|-------|-----------|---------|
| 7401 | Varsipari | L=125 | halk 12 | 1 |
| 7402 | Varsipari | L=250 | halk 12 | |
| 7403 | Varsipari | L=350 | halk 12 | |
| 7404 | Varsipari | L=500 | halk 12 | |
| | Varsipari | L=125 | hattu E13 | 2 |
| | Varsipari | L=250 | hattu E13 | |
| | Varsipari | L=350 | hattu E13 | |

Vesijäähdytteiset varsiparit 7946, 7913

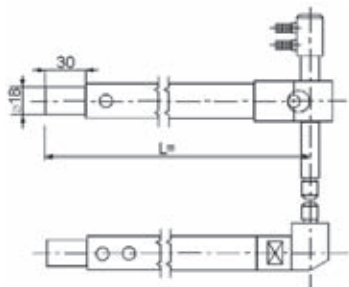

3

| Tuotekoodi | Tuote | | | Kuvanro |
|------------|-----------|-------|-----------|---------|
| 7512 | Varsipari | L=150 | suora 38 | 3 |
| 7513 | Varsipari | L=250 | suora 38 | |
| 7514 | Varsipari | L=350 | suora 38 | |
| 7515 | Varsipari | L=500 | suora 38 | |
| | Varsipari | L=150 | vino 38 | 4 |
| | Varsipari | L=250 | vino 38 | |
| | Varsipari | L=350 | vino 38 | |
| | Varsipari | L=500 | vino 38 | |
| | Varsipari | L=150 | hattu E13 | 5 |
| | Varsipari | L=250 | hattu E13 | |
| | Varsipari | L=350 | hattu E13 | |
| | Varsipari | L=400 | hattu E13 | |
| | Varsipari | L=500 | hattu E13 | |

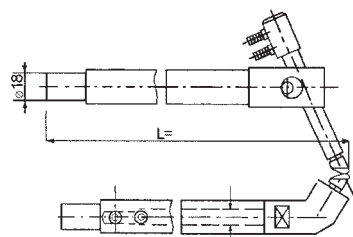

4

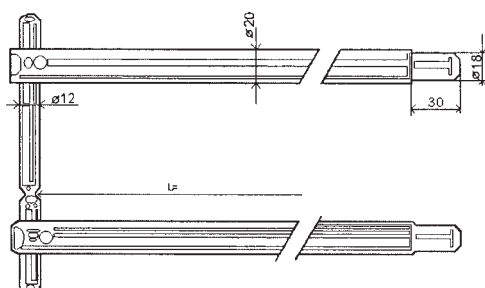

1

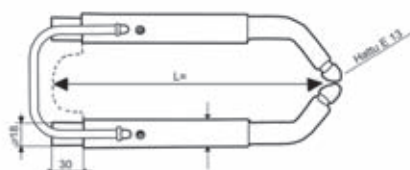

5

Pistehitsaustarvikkeet

Vesijäähdytteiset varsiarit VP-18, VP-25

| Tuotekoodi | Tuote | | | Kuvanro |
|-------------|----------|-------|----------|---------|
| 00100350001 | Ylävarsi | L=200 | suora 37 | 6 |
| 00100350003 | Alavarsi | L=200 | suora 37 | |
| 00100350021 | Ylävarsi | L=400 | suora 37 | |
| 00100350023 | Alavarsi | L=400 | suora 37 | |
| 00100350031 | Ylävarsi | L=500 | suora 37 | |
| 00100350033 | Alavarsi | L=500 | suora 37 | |
| 00100350041 | Ylävarsi | L=600 | suora 37 | |
| 00100350043 | Alavarsi | L=600 | suora 37 | |
| 00100350051 | Ylävarsi | L=800 | suora 37 | |
| 00100350053 | Alavarsi | L=800 | suora 37 | |

Erikoisvarret putkien hitsaukseen 4601-4607

| Tuotekoodi | Tuote | | | Kuvanro |
|---------------|-------|-------|-----------|---------|
| 00500304505 R | D=36 | L=550 | kartio 37 | 7 |
| X0700300724 R | D=36 | L=550 | kartio 47 | 8 |

Erikoisvarret putkien hitsaukseen 3064-9064

| Tuotekoodi | Tuote | | | Kuvanro |
|--------------|-------|-------|-----------|---------|
| 0100306654 R | D=40 | L=700 | kartio 37 | 7 |
| 0100309654 R | D=40 | L=700 | kartio 47 | 8 |

Erikoisvarret putkien hitsaukseen

| Tuotekoodi | Tuote | | | Kuvanro |
|-------------|-------|-------|-----------|---------|
| X0700300828 | D=50 | L=500 | kartio 37 | 9 |
| | D=58 | L=500 | kartio 37 | |
| | D=58 | L=300 | kartio 37 | |

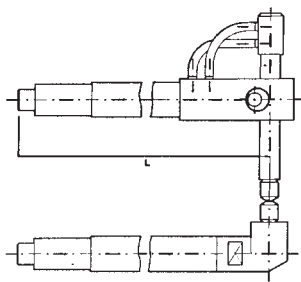

6

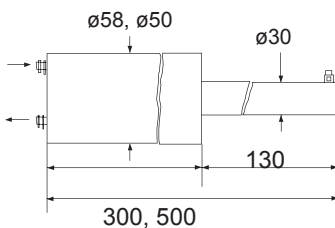

9

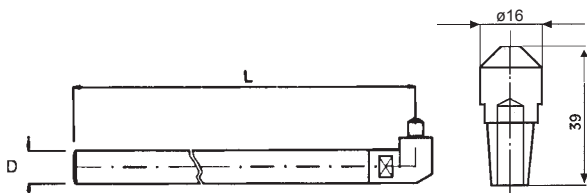

7

3720

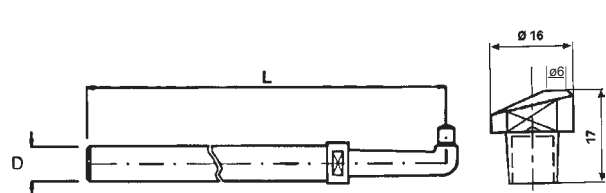

8

4727

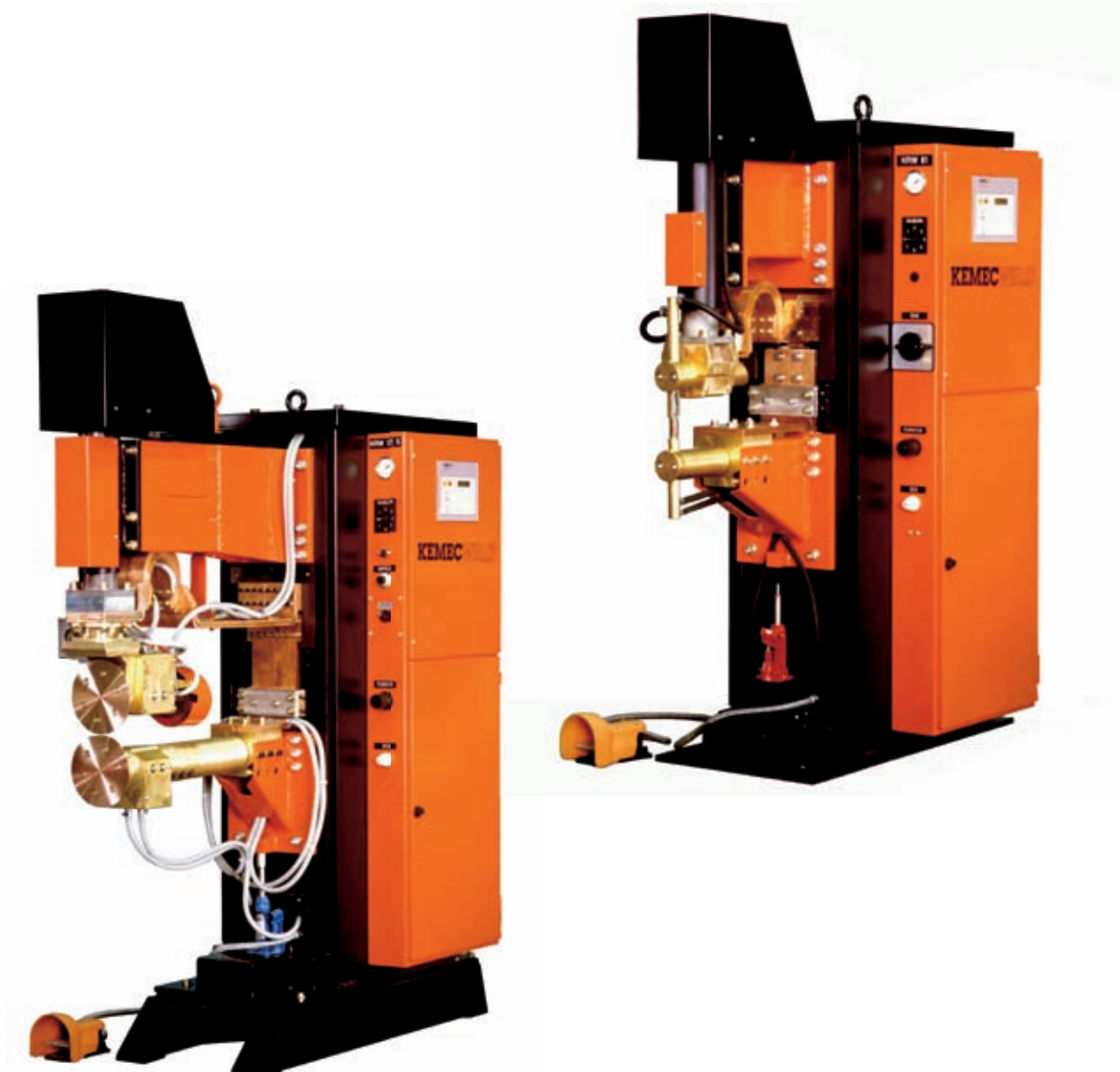

Masino Welding Oy

Kärkikuja 3, 01740 Vantaa
puh. 010 8345 500, faksi 010 8345 579
www.masino.fi, welding@masino.fi

Masino Welding Oy

U:ä^ä[} \ æ Å Ó F ä C H i € Á" \ ~
puh. 010 8345 500, faksi 010 8345 751
www.masino.fi, welding@masino.fi